

Universal Micrometer

Series 116

- Non-rotating spindle type which accepts seven forms of optional interchangeable anvil/spindle-tip (flat, spline, spherical, point, knife-edge, disc, and blade) for a wide range of applications.
- Optional anvils/spindle-tips for screw thread measurement (matching V and cone) are also available.

Specifications

Accuracy	Refer to the list of specifications
Graduation	0,01mm or 0.001"
Scales	Thimble and sleeve satin chrome finish, $\varnothing 18$ mm
Frame	Enamelled
Measuring spindle	with spindle lock, $\varnothing 8$ mm, spindle pitch 0,5 mm
Measuring force	5-10 N
Delivered	Including box, setting standard (from 25 mm upward), key Interchangeable anvils/spindle-tips not included

Optional accessories

No.	Description
116-801	Matched pair anvil/spindle-tip (flat)
116-802	Matched pair anvil/spindle-tip (spline)
116-803	Matched pair anvil/spindle-tip (spherical)
116-804	Matched pair anvil/spindle-tip (point)
116-805	Matched pair anvil/spindle-tip (knife-edge)
116-806	Matched pair anvil/spindle-tip (disc)
116-807	Matched pair anvil/spindle-tip (blade)
116-800	7 pairs of anvils/spindle-tips No. 116-801 to -807
116-830	6 pairs of anvils/spindle-tips for measuring metric threads, unified threads (60°)
116-840	10 pairs of anvils/spindle-tips for whitworth threads (55°)

116-830 :
 - 0,4-0,5 mm/64-48TPI (116-831)
 - 0,6-0,9 mm/44-28TPI (116-832)
 - 1-1,75 mm/24-14TPI (116-833)
 - 2-3 mm/13-9TPI (116-834)
 - 3,5-5mm/8-5TPI (116-835)
 - 5,5-7mm/4,5-3,5TPI (116-836)

116-840 :
 - 60-48TPI (116-841)
 - 48-40TPI (116-842)
 - 40-32TPI (116-843)
 - 32-24TPI (116-844)
 - 24-18TPI (116-845)
 - 18-14TPI (116-846)
 - 14-10TPI (116-847)
 - 10-7TPI (116-848)
 - 7-4,5TPI (116-849)
 - 4,5-3,5TPI (116-850)

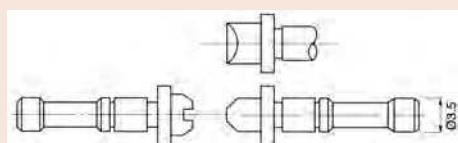

Interchangeable anvils/spindle-tips are available in sets and pairs



116-101

Metric

No.	Range	Accuracy	Mass g
116-101	0-25 mm	$\pm 4 \mu\text{m}$	250
116-102	25-50 mm	$\pm 4 \mu\text{m}$	300

Inch

No.	Range	Accuracy
116-105*	0 - 1"	± 0.0002 "
116-106*	1 - 2"	± 0.0002 "

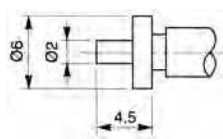

Spline
116-802

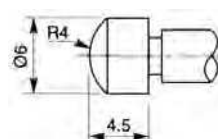

Spherical
116-803

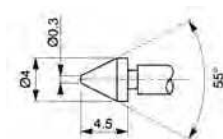

Point
116-804

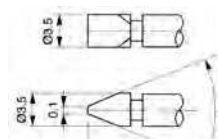

Knife-edge
116-805

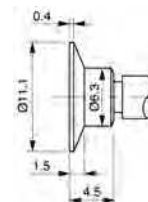

Disc
116-806

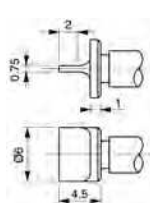

Blade
116-807

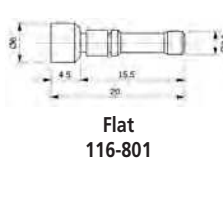

Flat
116-801