

Digimatic Screw Thread Micrometer

Series 326

- Optional, interchangeable, anvils/spindle-tips enable a wide range of Metric/Unified and Whitworth screw-thread pitch diameters to be measured.



326-251-10



Interchangeable anvils/spindle tips in matching pairs

Metric

No.	Range	Accuracy	A mm	B mm	Mass g
326-251-10	0-25 mm	±4 µm	39.5	25	350
326-252-10	25-50 mm	±4 µm	64.5	32	380
326-253-10	50-75 mm	±4 µm	90	45	470
326-254-10	75-100 mm	±5 µm	115.6	65	510

Inch/Metric

No.	Range	Accuracy	A mm	B mm	Mass g
326-351-10	0-1"	±4 µm/0.0002"	39.5	25	350
326-352-10	1-2"	±4 µm/0.0002"	64.5	32	380
326-353-10*	2-3"	±4 µm/0.0002"	90	45	470
326-354-10*	3-4"	±5 µm/0.00025"	115.6	65	510

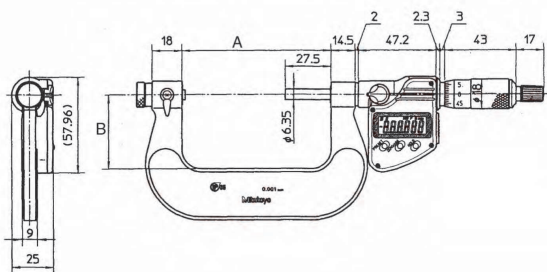

0-75 mm

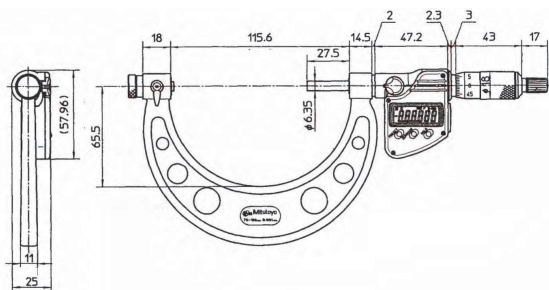

75-100 mm

Functions	Series 326
Data Output	●
ZERO/ABS	●
Auto Power OFF after 20 min. non use	●
HOLD	●
2 x PRESET	●
Low voltage alarm	●
Function lock	●

Specifications

Accuracy	Refer to the list of specifications (excluding quantizing error)
Digital step	0,001 mm or 0,001 mm/0.00005"
Scales	Thimble and sleeve satin chrome finish, ø18 mm
Frame	Enamelled
Measuring spindle	ø6,35 mm, spindle pitch 0,5 mm, with spindle lock
Measuring force	5-10 N
Battery life	approx. 1.2 years
Delivered	Including box, setting standard (60°) (from 25 mm upward), key, 1 battery

Standard accessories

No.	Description
167-261	Setting standard 25 mm/60° (25 - 50 mm)
167-262	Setting standard 50 mm/60° (50 - 75 mm)
167-263	Setting standard 75 mm/60° (75 - 100 mm)

Optional accessories

No.	Description
05CZA662	Digimatic cable with data switch (1 m)
05CZA663	Digimatic cable with data switch (2 m)
02AZD790B	Connecting cable U-Wave with data switch
167-272	Setting standard 25 mm/55°
167-273	Setting standard 50 mm/55°
167-274	Setting standard 75 mm/55°
167-275	Setting standard 100 mm/55°
06ADV380B	USB Input Tool Direct cable with data switch (2 m)

Consumable spares

No.	Description
938882	Battery SR44

Standard accessories for Inch

No.	Description
167-294	Setting standard 1"/60° (1 - 2")
167-295	Setting standard 2"/60° (2 - 3")
167-296	Setting standard 3"/60° (3 - 4")

Optional accessories for Inch

No.	Description
167-283	Setting standard 1"/55°
167-284	Setting standard 2"/55°
167-285	Setting standard 3"/55°
167-286	Setting standard 4"/55°



Anvil/spindle-tip matching pair