

Optional Arms and Styli

For CV-3000CNC, CV-4000CNC, SV-C3000CNC and SV-C4000CNC

Styli

Single bevel

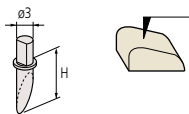

Tip angle: 12°
Tip radius: 25 µm
Tip material: Carbide

Cross ground

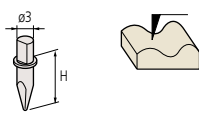

Tip angle: 20°
Tip radius: 25 µm
Tip material: Carbide

Cone

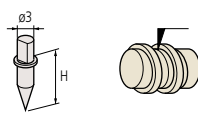

Tip angle: 20°
Tip radius: 25 µm
Tip material: Carbide

Cone

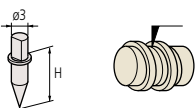

Tip angle: 30° (SPH-79: 50°)
Tip radius: 25 µm
Tip material: Carbide, Sapphire (SPH-79: Diamond)

Knife edge

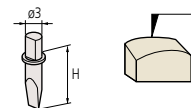

Tip angle: 20°
Edge width: 3 mm
Tip radius: 25 µm
Tip material: Carbide

Ball

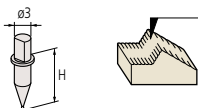

Ball diameter: 1 mm
Tip material: Carbide

Small hole: 12AAE297

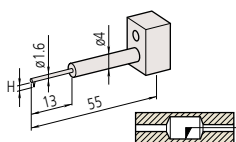

Tip shape: Single bevel
Tip angle: 20°
Tip radius: 25 µm
Tip material: Carbide

Small hole: 12AAE298

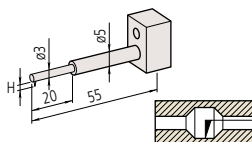

Tip shape: Single bevel
Tip angle: 20°
Tip radius: 25 µm
Tip material: Carbide

Small hole: 12AAE299

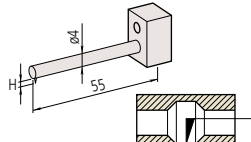

Tip shape: Single bevel
Tip angle: 20°
Tip radius: 25 µm
Tip material: Carbide

Stylus No.	Code No.	Compatible arm No.	H (mm)
------------	----------	--------------------	--------

Single-bevel stylus carbide-tipped

SPH-51	354882	ABH-52, 53	6
SPH-61	354883	ABH-62, 63	12
SPH-71*	354884	ABH-71, 72	20
SPH-81	354885	ABH-81, 82	30
SPH-91	354886	ABH-91, 92	42

Cross-ground stylus carbide-tipped

SPH-52	354887	ABH-52, 53	6
SPH-62	354888	ABH-62, 63	12
SPH-72	354889	ABH-71, 72	20
SPH-82	354890	ABH-81, 82	30
SPH-92	354891	ABH-91, 92	42

Cone stylus carbide-tipped tip angle 20°

SPH-57	12AAE865	ABH-52, 53	6
SPH-67	12AAE866	ABH-62, 63	12
SPH-77	12AAE867	ABH-71, 72	20
SPH-87	12AAE868	ABH-81, 82	30
SPH-97	12AAE869	ABH-91, 92	42

Cone stylus sapphire-tipped tip angle 30°

SPH-53	354892	ABH-52, 53	6
SPH-63	354893	ABH-62, 63	12
SPH-73	354894	ABH-71, 72	20
SPH-83	354895	ABH-81, 82	30
SPH-93	354896	ABH-91, 92	42

Cone stylus diamond-tipped tip angle 50°

SPH-79	355129	ABH-52, 53	20
--------	---------------	------------	----

*Supplied as standard

Stylus No.	Code No.	Compatible arm No.	H (mm)
------------	----------	--------------------	--------

Cone stylus carbide-tipped tip angle 30°

SPH-56	12AAA566	ABH-52, 53	6
SPH-66	12AAA567	ABH-62, 63	12
SPH-76*	12AAA568	ABH-71, 72	20
SPH-86	12AAA569	ABH-81, 82	30
SPH-96	12AAA570	ABH-91, 92	42

Knife-edge stylus carbide-tipped

SPH-54	354897	ABH-52, 53	6
SPH-64	354898	ABH-62, 63	12
SPH-74	354899	ABH-71, 72	20
SPH-84	354900	ABH-81, 82	30
SPH-94	354901	ABH-91, 92	42

Ball stylus carbide-tipped

SPH-55	354902	ABH-52, 53	6
SPH-65	354903	ABH-62, 63	12
SPH-75	354904	ABH-71, 72	20
SPH-85	354905	ABH-81, 82	30
SPH-95	354906	ABH-91, 92	42

Small-hole stylus carbide-tipped cone

SPH-21	12AAE297	ABH-21	0.4
SPH-22	12AAE298		1
SPH-23	12AAE299		2.5

*Supplied as standard

Note: Any specified arm and stylus other than those listed above can be custom made to special order.

Arms

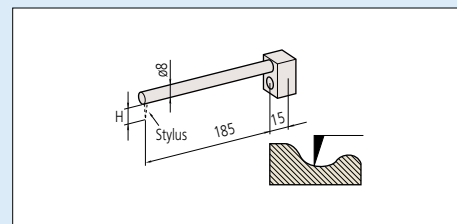

Straight type

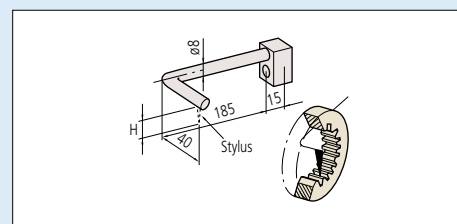

Eccentric type

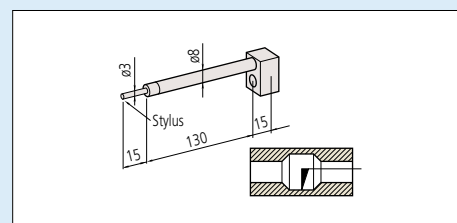

For small-hole stylus

Arm No.	Code No.	Compatible stylus No.	H (mm)
ABH-53	12AAE294	SPH-5x	6
ABH-63	12AAE295	SPH-6x	12
ABH-71*	996506	SPH-7x	20
ABH-81	996507	SPH-8x	30
ABH-91	996508	SPH-9x	42

Straight type

ABH-52	996509	SPH-5x	6
ABH-62	996510	SPH-6x	12
ABH-72	996511	SPH-7x	20
ABH-82	996512	SPH-8x	30
ABH-92	996513	SPH-9x	42

Small hole

ABH-21	12AAE296	SPH-2x	—
--------	-----------------	--------	---

*Supplied as standard